

- MODELS:
- PFM 9.2
 - PFM 9.0
 - PFM900
 - VBG620



● 2002 Dodge 1/2-Ton Truck Update



30-791 spacer

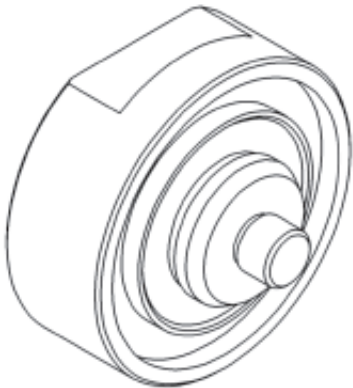

50-046 nose cone spacer

The 2002 Dodge 1/2-Ton Trucks have larger lug nuts that interfere with our adapter, 50-691 rev 7.

The pattern is the same, 5 on 5.5". An after market lug nut is required. Size: 9/16" x 18-stud 7/8" hex. The Pro-Cut lug nut kit now contains these lug nuts (red colored; part #50-179).

The studs have a slight shoulder on them. A 30-791 spacer (left) is required so that the adapter sits flush.

The gearbox interferes with the rotor. A 50-046 nose cone spacer (left) is required to space out the gearbox. Do not under any circumstances grind down lathe or gearbox body!

Contact the Pro-Cut Service Department with any questions: 800-543-6618.



Now with factory-trained sales and service across the country!